

GORILLA ZILLA PRODUCTS (PTY LTD).

Sub-contracted for:

Measurements

3D Concept design

Detail drawings of parts for prototype & production versi

Factory Assembly Drawings

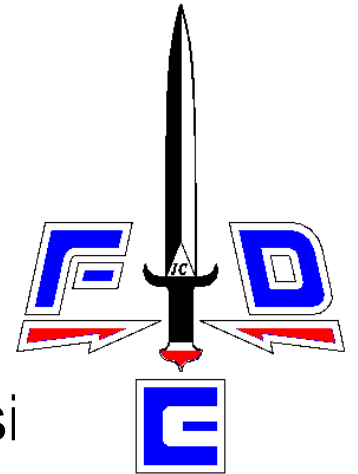

Market:

Super Sport motorcycle, aftermarket, adjustable foot pegs.

This document give more information about the designs done from July 2006 to October 2008.

Ducati 1098 2007-2008  
Ducati 1198 2009  
Honda CBR 600 2007-2008  
Honda CBR 1000 2008-2009  
Kawasaki ZX10 2006-2007  
Kawasaki ZX10 2008-2009  
Suzuki GSXR750 2006-2007  
Suzuki GSXR750 2008-2009  
Suzuki GSXR1000 2007-2008  
Suzuki B KING 2008-2009  
Yamaha R6 2006-2009  
Yamaha R1 2007-2008

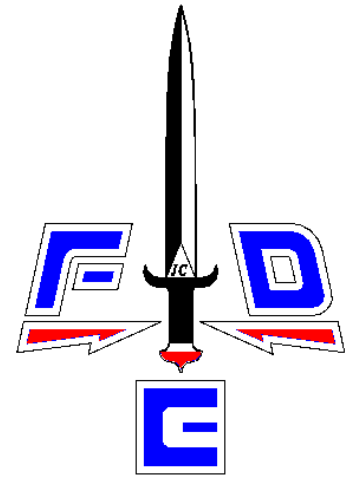

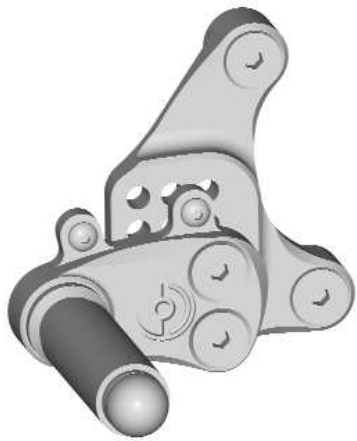
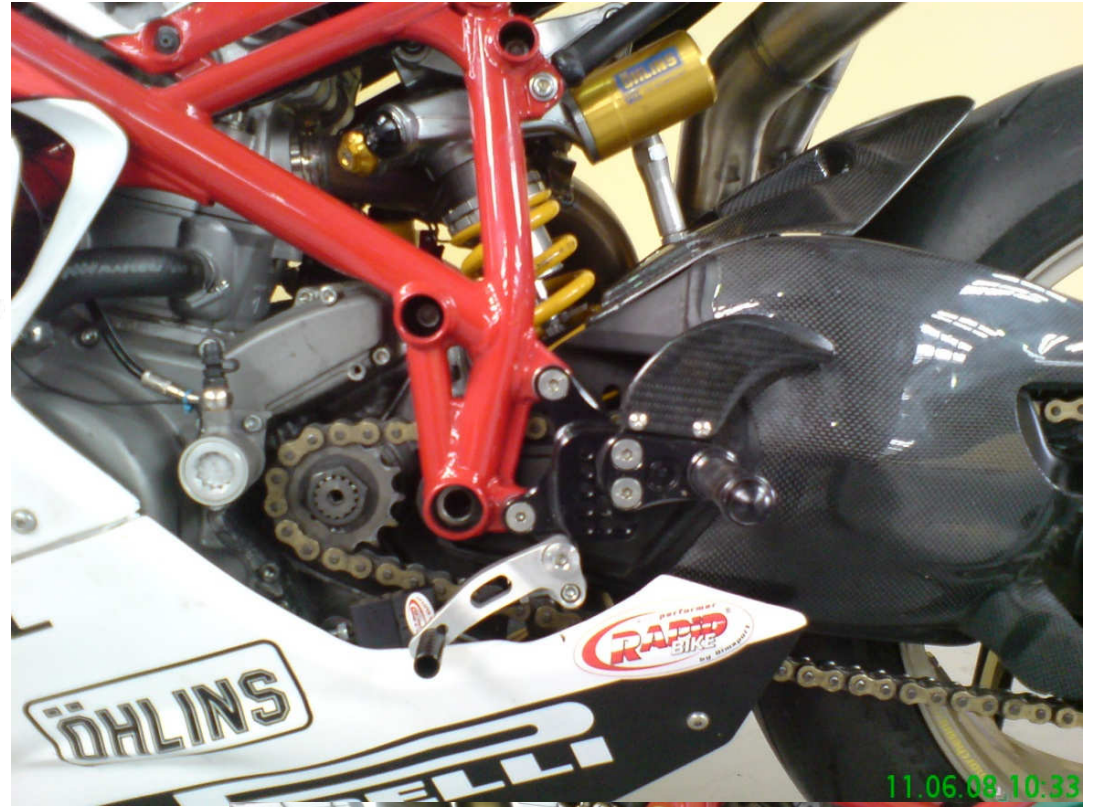
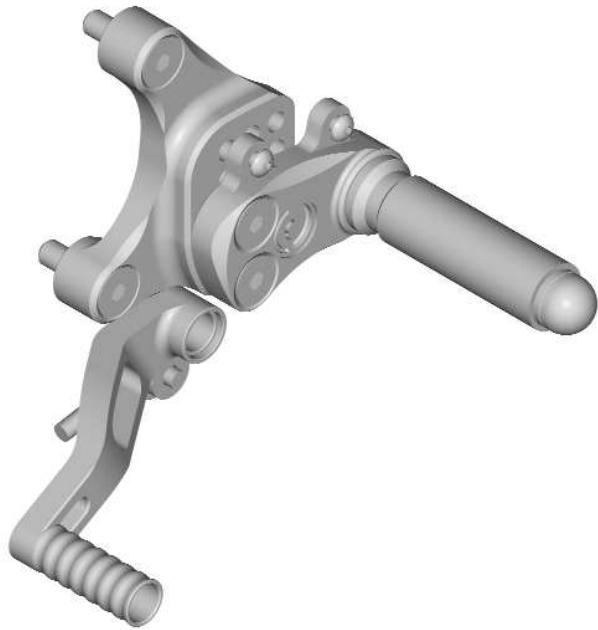

DUCATI 1098

11.06.08 10:33



# YAMAHA R6 2006-2009

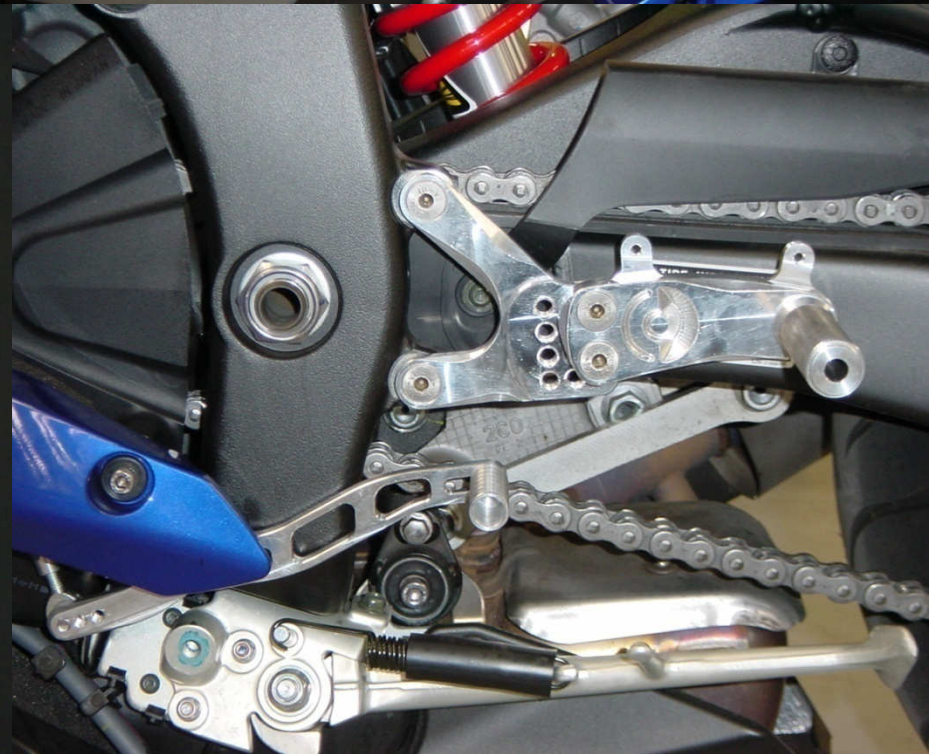
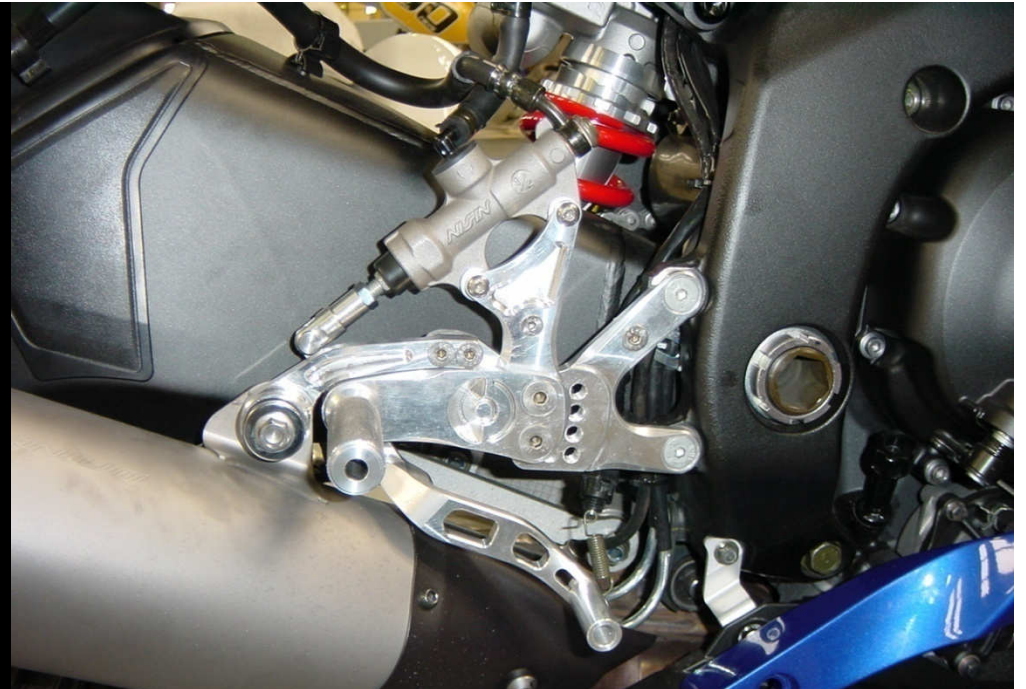
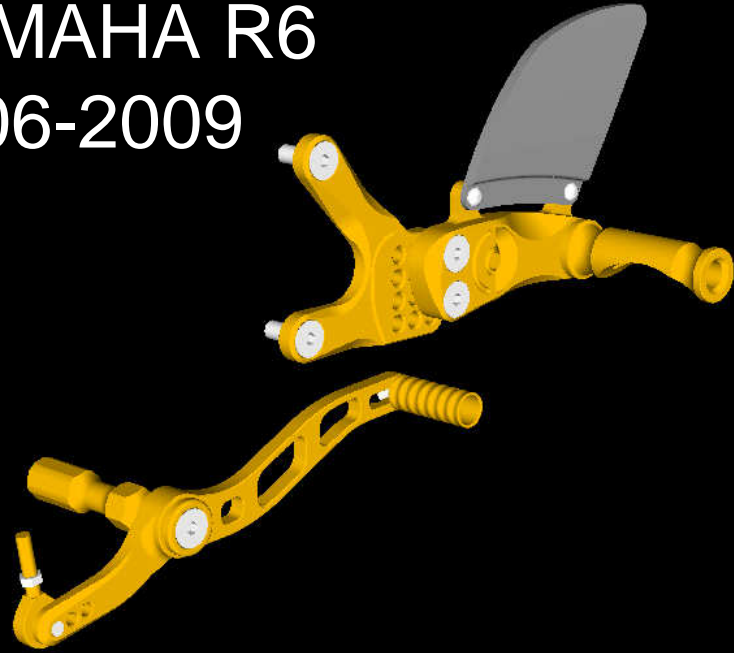



# YAMAHA R1 2007

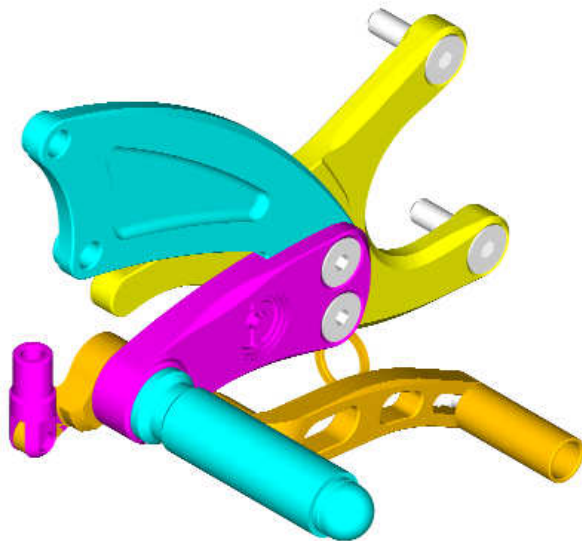
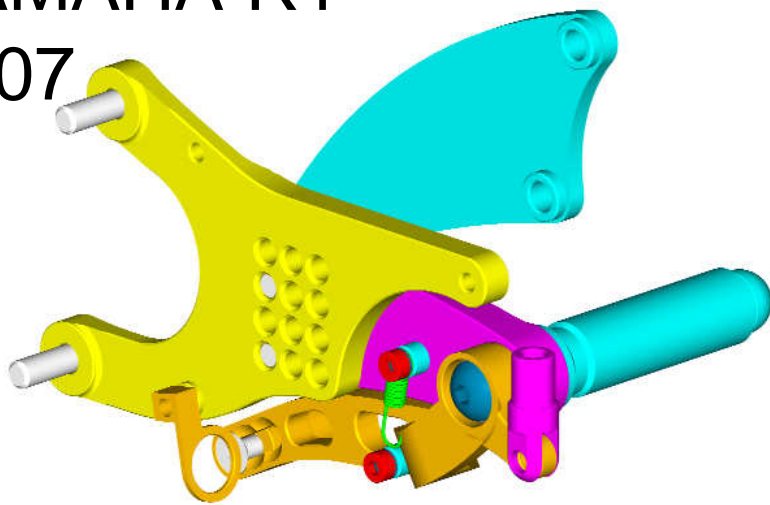

# HONDA CBR

1000 2008

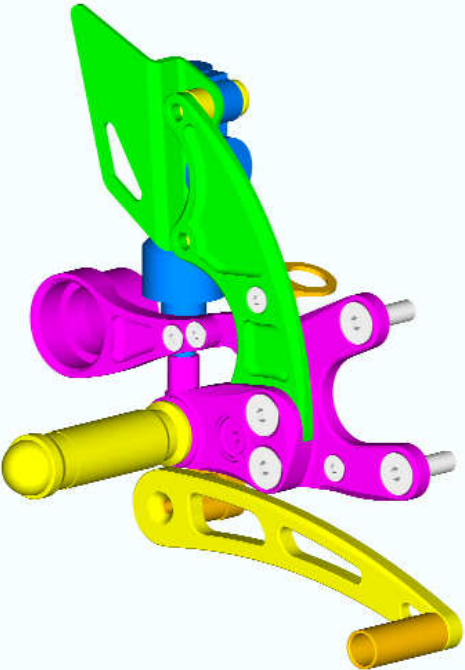
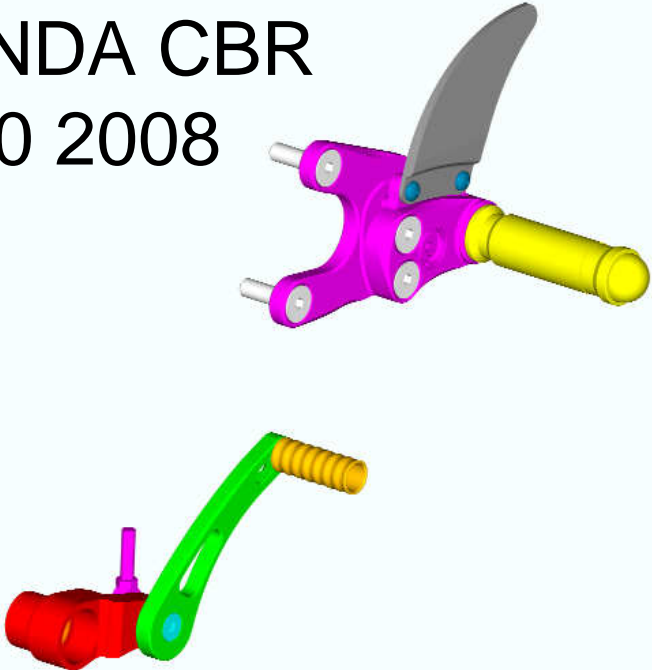



# HONDA CBR 600 2007

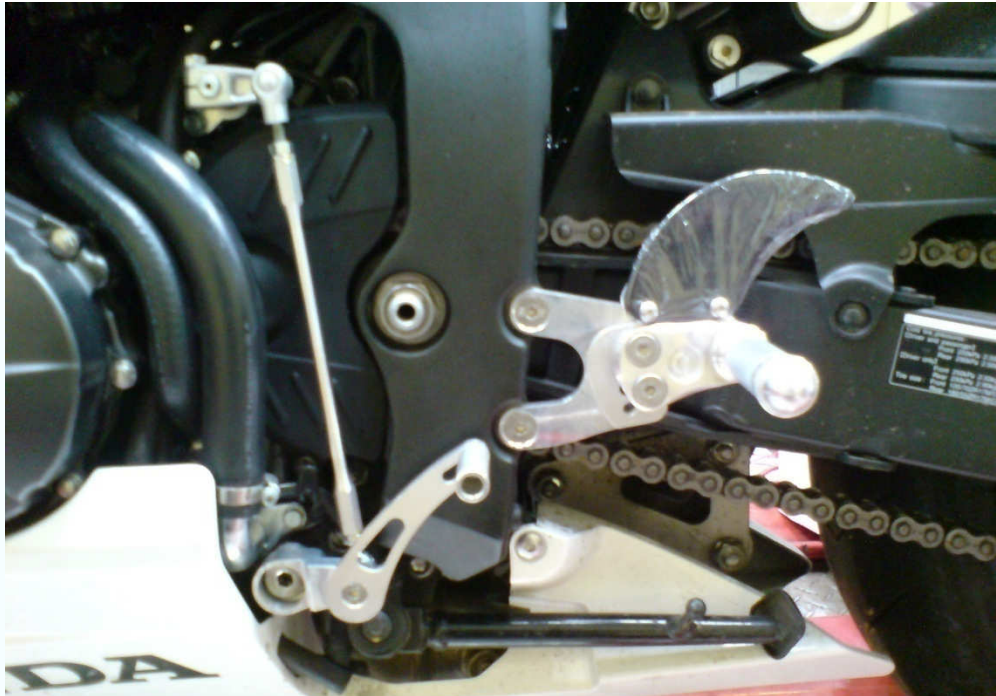
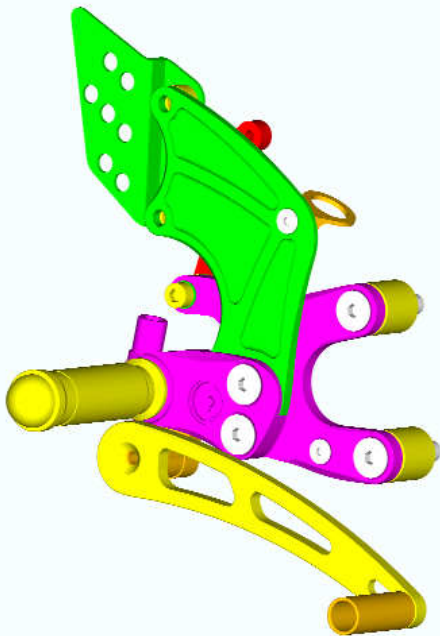
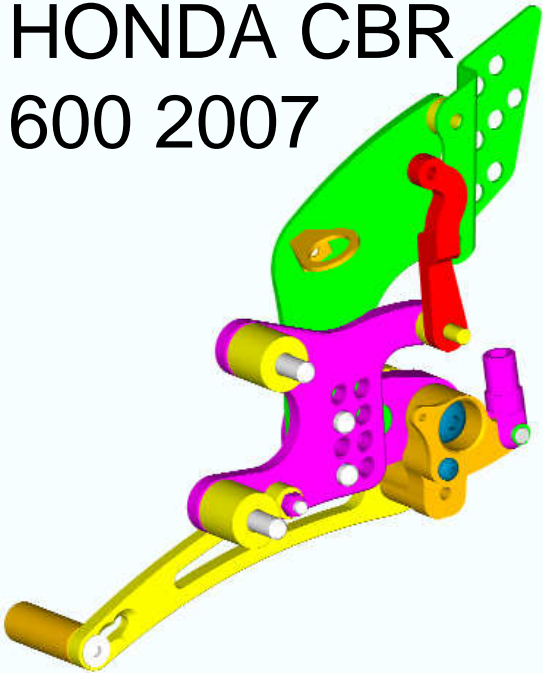



# KAWASAKI ZX10 2008

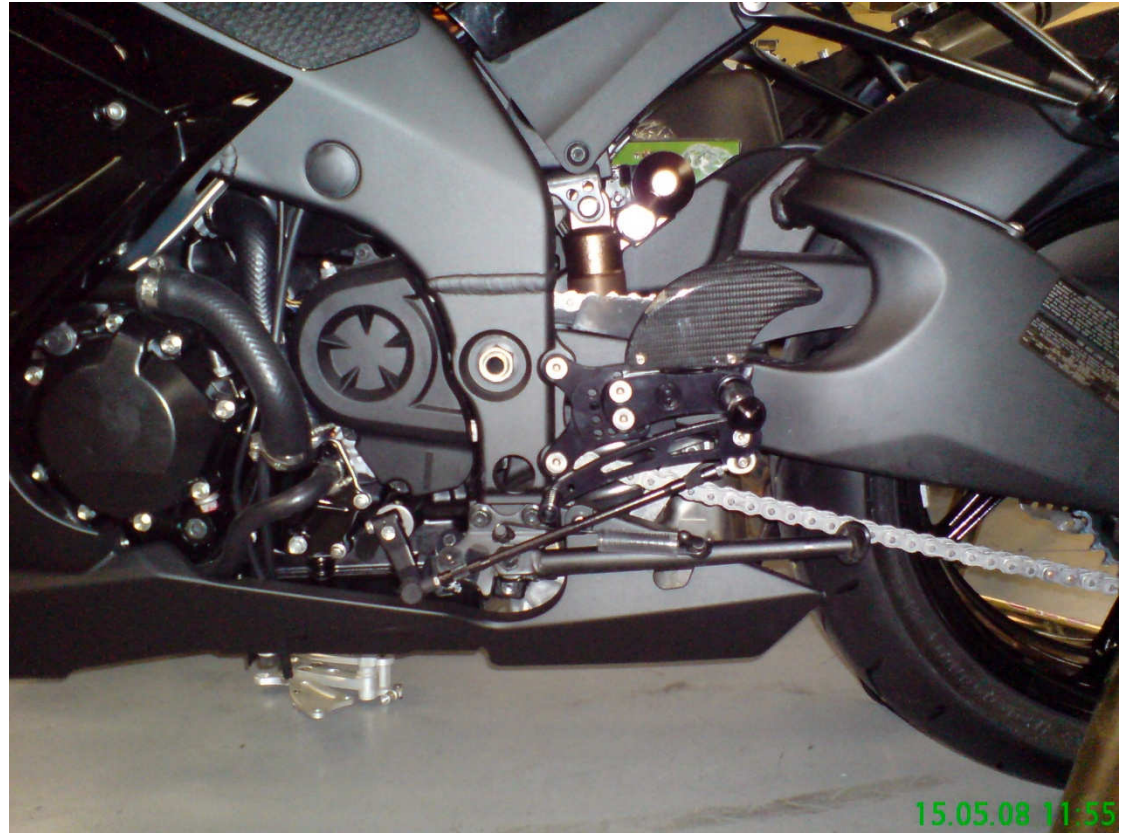
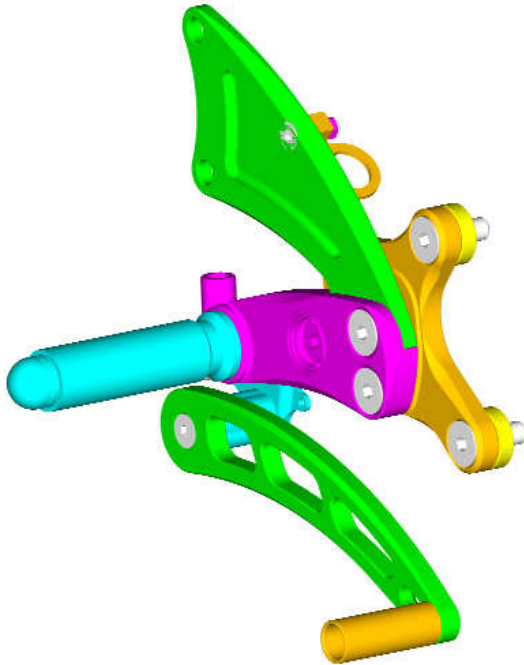
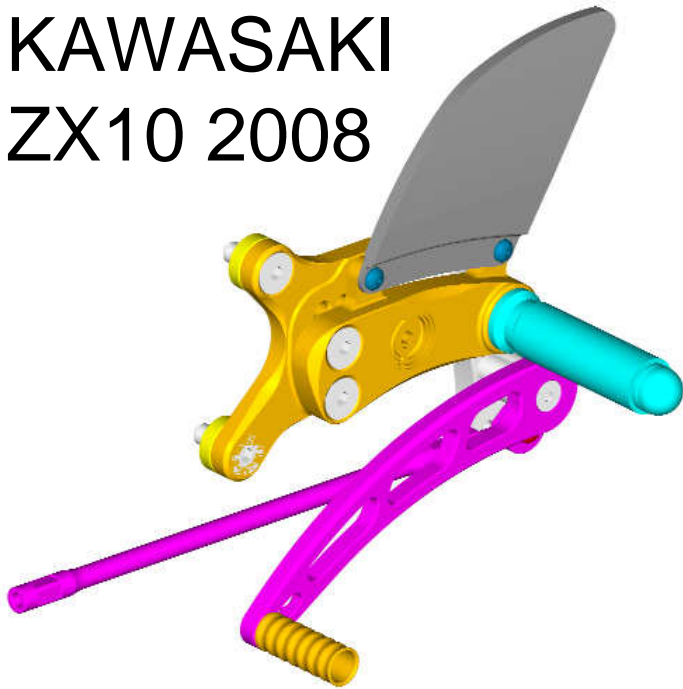



# SUZUKI B KING 2008

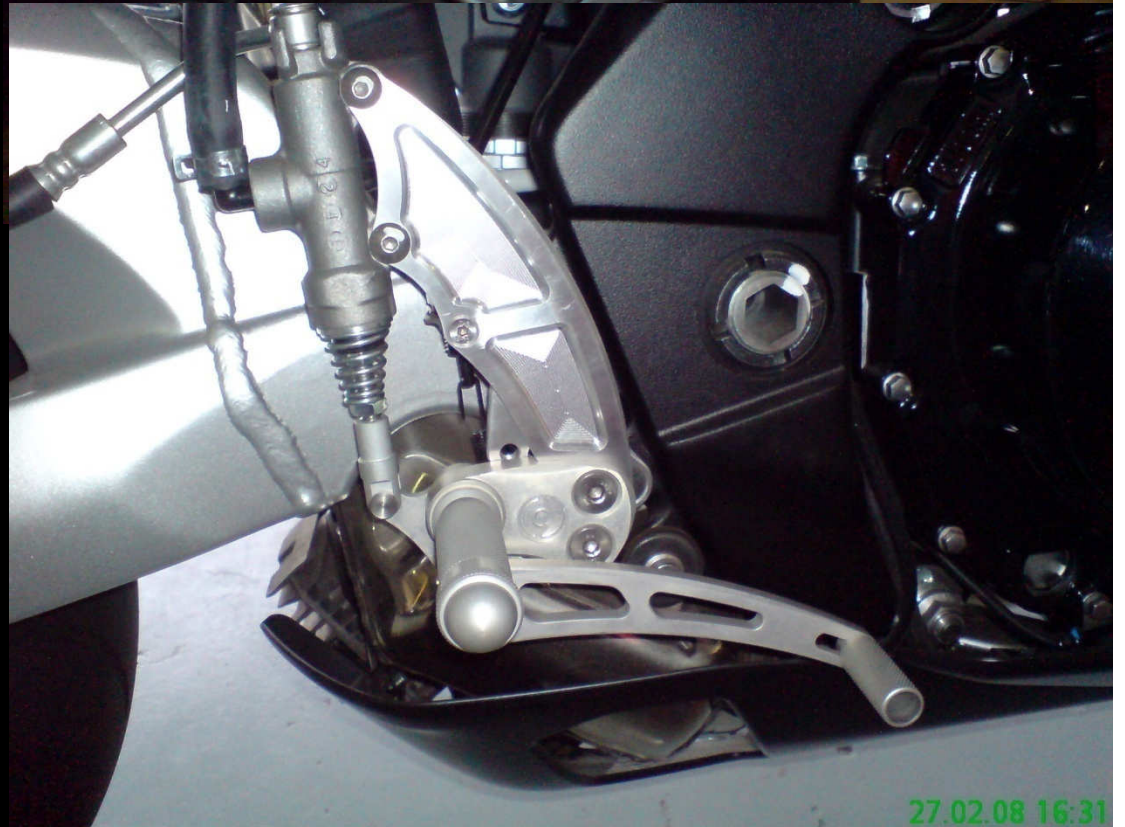
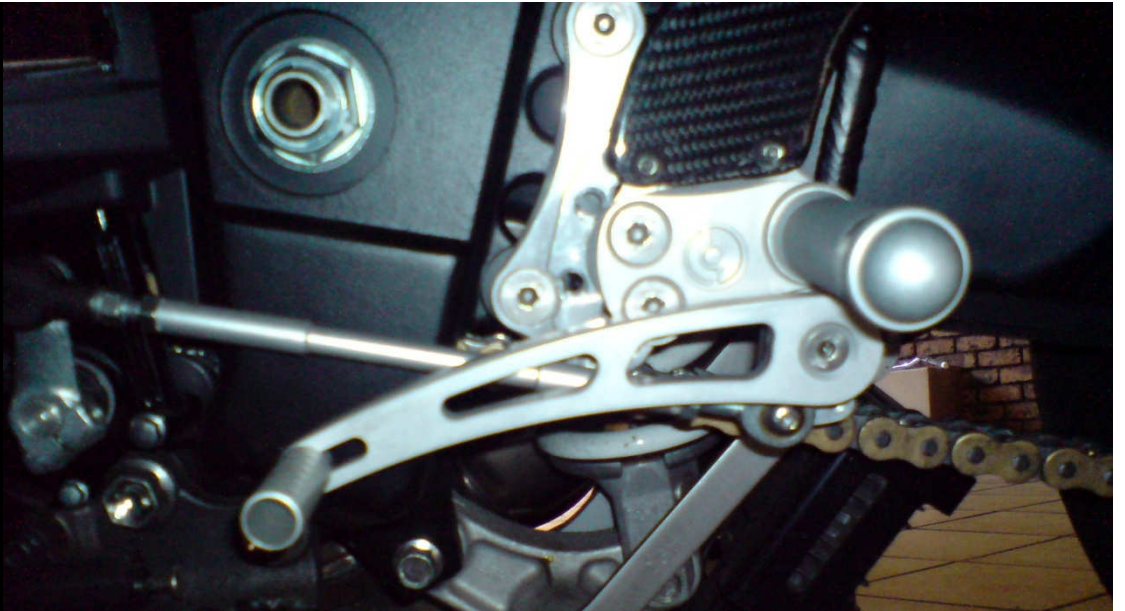
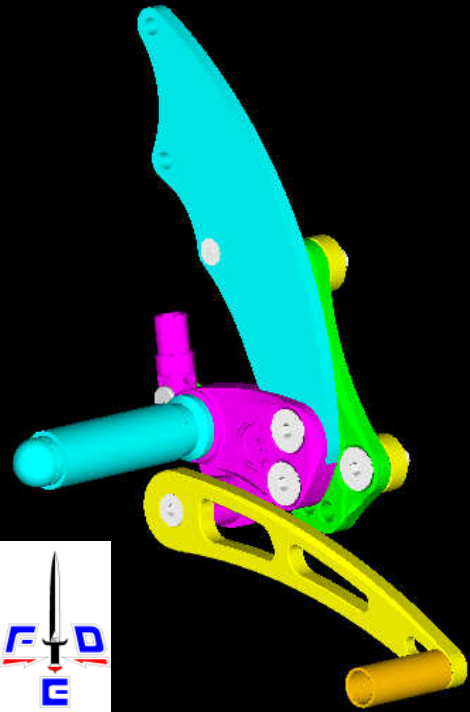
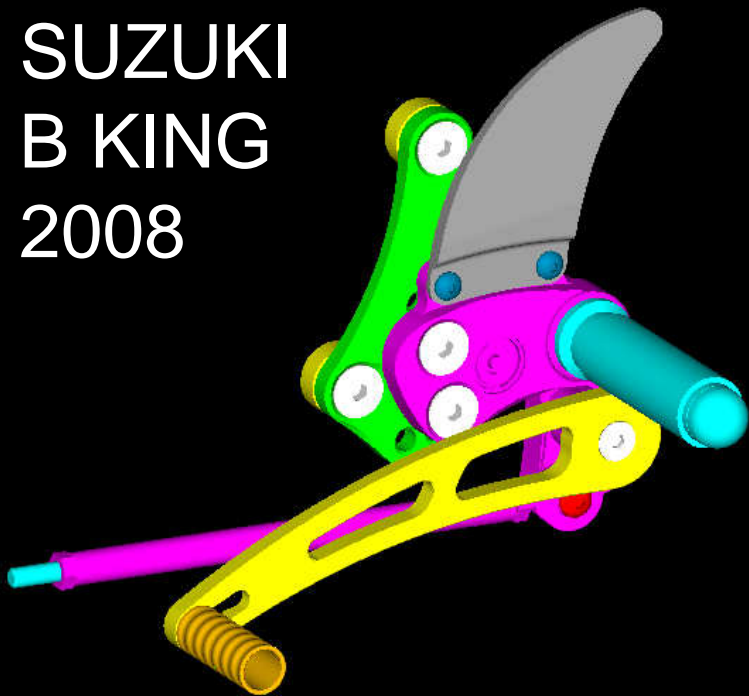

27.02.08 16:31